

INSTRUCTION MANUAL

(To see our video, please scan the QR code on the frame)

11 Certificate

SONG OF YOUTH Folding Bicycle	
Certificate of Quality	
Bicycle Serial Number:	
Bicycle Model:	
Color:	
Date of Production:	
Inspector (Stamp):	Inspection Result (Stamp):

12 After-sale

After-sale service station

CONTENT

Structural components illustration.....	2
Operational method	3
Unpacking and Assembly.....	4
Fold and Unfold.....	5
Components Regulation, Disassembly and Assembly	7
Torque of Screw Components	10
Safety Tips and Considerations	11
Other Considerations	12
Maintenance	13
Warranty	14
Certificate.....	16
After-sale	16

Thank you for purchasing SONG OF YOUTH folding bicycle produced by Changzhou Golden Ages Vehicle Co., Ltd in China. This bicycle is a kind of high-end portable carbon fiber bicycles taking two years to be developed featured by its naturally outstanding light luxury single product and globally covered 21 patents. It is suitable for urban leisure, tourism, business traveling and other purposes.

2 Structural components illustration

- | | | |
|----------------------|-----------------------------|---------------------|
| ① Frames | ⑦ Pedal | ⑫ Speed sensor |
| ② Folding device | ⑧ Cranks | ⑬ Head light switch |
| ③ Quick release lock | ⑨ Tail light | ⑭ Display |
| ④ Disc-brake | ⑩ Kickstand(use for fold) | ⑮ Head light |
| ⑤ Disc-brake pad | ⑪ Kickstand(use for unfold) | ⑯ motor |
| ⑥ Fender | | |



10 Warranty

During the period of warranty, malfunction and damages due to the following reasons are beyond the scope of the warranty of repairing.

The store may provide the repairing service by charging the cost and the repairing expenses.

- ① Do not use it in accordance with the User Manual provided with the bicycle.
- ② Do not make proper maintenance and repairing in accordance with the Repairing Specification.
- ③ Collision due to accident or inaccurate application.
- ④ Damages caused by application of the bicycle at a general place not professionally designed for this bicycle.
- ⑤ Repaired by the special repairing store not recognized by the company.
- ⑥ Refit or replacement of the original specification and color, as well as the components not specified by the original factory of the company.
- ⑦ Proper maintenance or replacement is failed to be conducted timely after the consumption of consumables, resulting in the malfunction or damages to other components.
- ⑧ The tire is stabbed by sharp substance, resulting in leakage or tire burst.
- ⑨ Bicycle leasing or abnormal application.

User maintenance record					
Date of purchase		Bicycle serial number		Product model	
Warranty date		Warranty content		Note	
Agent (Stamp)				Telephone	
				Address	

Whether the pedal is loose or worn	Inspection	Inspection and Lubrication	Inspection	Inspection and Lubrication	Inspection
Whether the splash guard is deformed or loose	Inspection	Inspection	Inspection	Inspection	Inspection
Whether the reflector is loose, polluted, or broken	Inspection	Inspection	Inspection	Inspection	Inspection
Whether the bell is loud and clear	Inspection	Inspection	Inspection	Inspection	Inspection
Whether the frame folder is loose	Inspection	Inspection and Adjustment	Inspection	Inspection and Adjustment	Inspection
Whether the front cross is loose	Inspection	Inspection and Adjustment	Inspection	Inspection and Adjustment	Inspection
Whether the handlebar and front riser is loose	Inspection	Inspection and Adjustment	Inspection	Inspection and Adjustment	Inspection
Whether the wheel rim runs out	Inspection	Adjustment	Inspection	Adjustment	Inspection
Whether the handlebar and saddle are in an appropriate height	Inspection	Adjustment	Inspection	Adjustment	Inspection

10 Warranty

Warranty period of the frame: within 2 years since the purchasing date

Warranty period of general components: within 1 year since the purchasing date
General components include front fork, rim, seat cushion, freewheel, fluted disc, crank, pedal, main axle, front hub, rear hub, handlebar straight, handlebar stem, front and rear disc-brake, brake handlebar, liner band, rack, folding device hand lever.

Consumables: beyond the scope of warranty

Consumables include outer tire, inner tire, chain, fender, spoke, bell, disc-brake pad, brake cable, bicycle lamp.

Within the following period of warranty, you can request a complete after-sale service to the existing exclusive bicycle store of the original purchase for the malfunction of your bicycle in the case of a normal application in accordance with the User Manual provided with the bicycle.

2 Operation method

Charging:

- 1) Insert the DC plug into the charger jack under the saddle when you are charging. The red button is power switch. "I" is open, and "O" is close.
- 2) The light of the charger is red when charging, it will turn green when the battery is charged full.

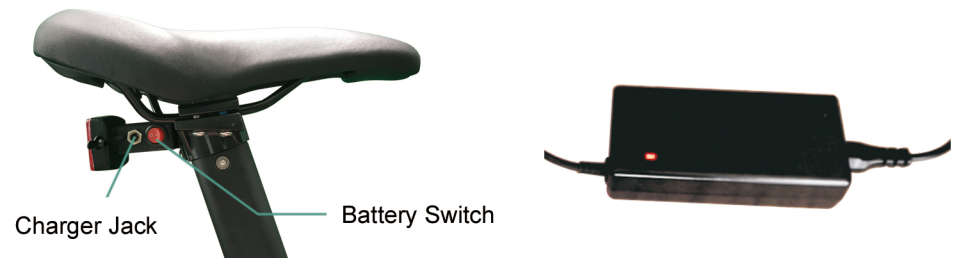

Riding:

Turn the switch (under the saddle) to "I", then long press the power button of the instrument to turn it on. Just pedaling to use the pedal assist mode. Press the "+" button to switch to second gear and third gear. Press the "-" button to switch to second gear and first gear. Press the thumb shifter to use the pure electric mode. You can ride the bike without pedaling in this mode.

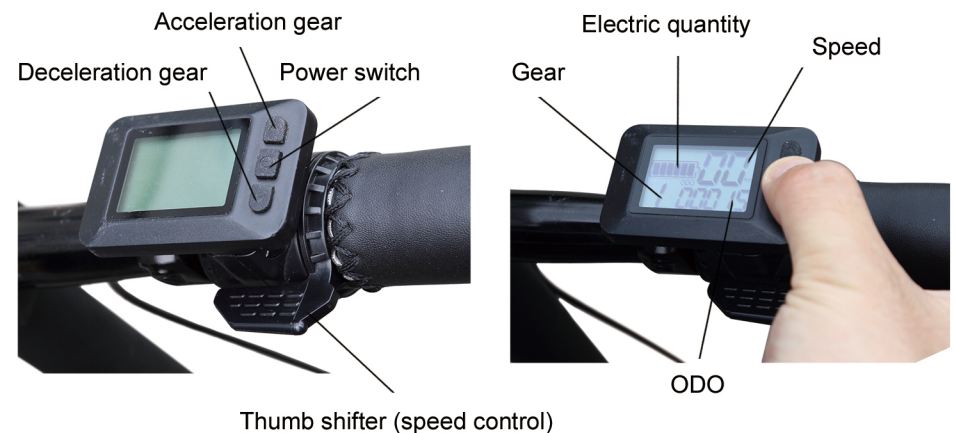

3 Unpacking and Assembly

Please make an inventory for the articles within the package based on the following list upon unpacking:

①Major frame ②Pedal ③Kickstand ④Basic handle tools ⑤Specification

Assembly:

1) Open the carton and take out the bicycle parts. Unfold the kickstand (use for fold) (as shown in Figure 1)

2) Install the pedals to the crank by a 15# open spanner. Refer to the L/R marks on the pedals making pedal with the mark "L" on the left of the frame and tighten up it with the kickstand (use for unfold) by anti-clockwise rotation (as shown in Figure 2-3); while making pedal with the mark "R" on the right of the frame and tighten up it by clockwise rotation. (as shown in Figure 4)

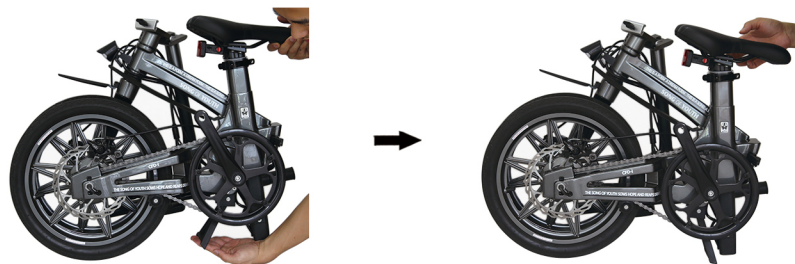

Figure 1



Figure 2



tighten up it by anti-clockwise rotation

Figure 3



tighten up it by clockwise rotation

Figure 4

9 Maintenance of the Bicycle

Generally, after a period of cycling, the components of the bicycle will be loose, worn or even damaged due to many factors. So regular inspection and maintenance are necessary to be carried out at usual time to not only prevent the components from loosening or damage thus resulting in the occurrence of accidents, but also prolong the service life of the bicycle. The maintenance of the bicycle mainly consists of the following parts:

① Lubricating: the lubricating positions such as the front and rear axles, bottom bracket, and headset shall be regularly lubricated, generally by grease. The bottom bracket and the headset of the bicycle are precise components, for which liquid lubricating oil such as pneumatic tool oil (sewing machine oil, and so on) shall be adopted.

② Inspection: Brake, wheel, handlebar and illumination and other equipment shall be inspected regularly.

③ Screw up: the fasteners of the handlebar, stem, saddle and wheel shall be inspected regularly.

④ Regulation: the controlling parts of the bicycle shall be inspected regularly.

⑤ Replacement: Over worn or damaged components shall be replaced promptly. The belt shall be replaced once every year. Specific contents above are shown in "Regular Maintenance Form".

The Inspection Items	2 Months	6 Months	1 Year	1.5 Years	2 Years
Whether the handlebar components and rotating parts are loose or worn	Tighten up	Check on the lubrication	Check on the lubrication	Check on the lubrication	Check on the lubrication
Whether the front and rear flower drums and the axles are loose or worn	Tighten up	Check on the lubrication	Check on the lubrication	Check on the lubrication	Check on the lubrication
Whether the middle axle component is loose or worn	Tighten up	Check on the lubrication	Check on the lubrication	Check on the lubrication	Check on the lubrication
Whether the tires are appropriately aerated Whether the external tires are seriously worn or damaged	Inspection	Inspection	Change	Inspection	Change
Whether there is damage on the braking lining	Inspection	Inspection	Change	Inspection	Change
Whether the braking effect is good or not	Inspection	Inspection	Inspection	Inspection	Inspection
Whether there is deformation or damage on the frame, front cross and the wheel rim	Inspection	Inspection	Inspection	Inspection	Inspection
Whether there is deformation on the tooth plate and the crank	Inspection	Inspection	Inspection	Inspection	Inspection

7) Do not use this bicycle for cross-country, downhill, jump, stunt and other extreme sports or other substantially dangerous movements. Inaccurate application will result in hurt to riders and serious damage to the bicycle.

8) When you have ridden 40km for the first time, please check the nuts of the crank to make sure they are tightened up to guarantee the ridding security.

9) Please check the reflectors and reflector mounting bracket regularly to make sure they are clean, straight and tightened up without crack. If they are damaged, please go to the agent or the repairing center to replace new ones. If they are crooked or loose, please fix it correctly in time.

8 Other Considerations

1) Lock the wheel

The wheel of this bicycle is unilaterally locked. Please check if there is any loosening at the axle before the cycling.

2) Regulation of the brake and recommendations for the replacement of disc-brake lining shoe:

① In the case of a negative adjustment of brake or severely worn of lining shoe, cycling will be a threat to the safety of the riders. Please regulate or replace relevant accessories in time.

② Brakes of your bicycle have been set and regulated before delivery that the left brake handlebar can control the rear brake while the right brake handlebar can control the front brake. Please make sure your hands can hold and completely press the brake handlebars.

③ Braking of the bicycle is based on the friction between the disc-brake pad and the brake lining shoe. In order to guarantee the maximum braking force, please keep the cleanness of the disc-brake pad and brake lining shoe, making sure there is no dust, lubricants and other substances which can reduce the friction.

④ The braking system is designed for controlling the speed rather than simply stopping the bicycle.

⑤ The brake lining shoe is easy to be worn. Please adjust the brake properly or replace the brake lining shoe based on the worn situations.

⑥ Warning: Please make sure no any oil or lubricants contacting the disc-brake pad or the brake lining shoe.

⑦ Replacement of the brake lining shoe is limited to be carried out by the brake manufacturers authorized by the original factory.

4 Unfold and Fold

Unfold

1) Unfold the frame by holding the seat cushion by the right hand and holding the handlebar pedestal by the left hand(as shown in Figure 5), keeping the palm of left hand outward while keeping the façade of the front fork on the left of the frame(as shown in Figure 6-7). Lock the folding device of the frame and the safty insurance(as shown in Figure 8).

2) Lock the quick release of the stem(as shown in Figure 9).

3) Unlock the quick release of the seat tube, pull up the saddle and reset it by rotating it until it rises to a proper height , lock the quick release(as shown in Figure 10).



Figure 5



Figure 6



Figure 7



Figure 8



Figure 9



Figure 10

4 Unfold and Fold

Fold:

- 1) Fold the saddle: unlock the quick release of the seat tube, lay down the seat tube, drop the saddle slightly to the bottom and lock the quick release (as shown in Figure 11).
- 2) Fold the frame: unlock the quick release of the stem (as shown in Figure 12), unlock the safety insurance and folding device of the frame (as shown in Figure 13), hold the saddle with right hand, left hand on the bottom of the handle-bar. Put down the handle-bar to left side and pull back in the same time, keeping the direction of the front wheel unchanged during the pulling back process (as shown in Figure 14) and making the front and rear wheels completely fit, magnetic clasps setting for the front and rear wheel axles can automatically suck the wheels (as shown in Figure 15).
- 3) Fold the pedal: As shown in Figure 15-16, slightly press the pedal inward to fold it.



Figure 11



Figure 12



Figure 13



Figure 14



Figure 15



Figure 16

7 Safety tips and considerations

- 1) Security mark illustration for Seat tube and handlebar stem.

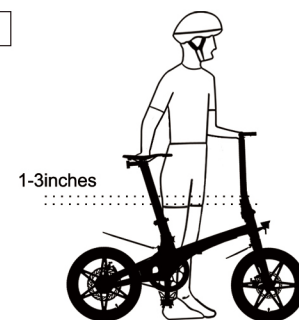
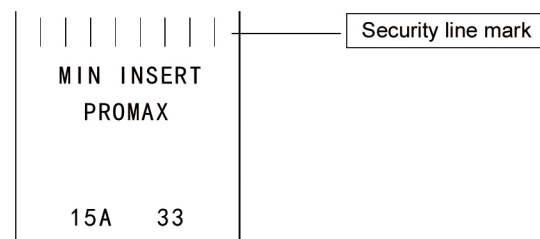

- 2) Weight limit: 100kg
- 3) Please wear the helmet before riding.

Safety considerations before riding

Attention: all parts for adjustment of your bicycle have been regulated in advance. But if further adjustment is needed when using it, you may adjust it to ensure its best working condition. (adjustment methods are shown in P5-11)

Warnings:

- 1) Before every cycling, please carefully check the braking system, tires, handlebar, folding clasp and other parts of your bicycle to make sure it is under a favorable working condition.
- 2) It is your responsibility to abide by the relevant laws of the riding region, including allocation of relevant devices specified by the laws for yourself and your bicycle.
- 3) In rainy days, the grip of the tires and the function of the braking system of the bicycle will be affected that the braking force of the bicycle will be greatly reduced which will make it more difficult to control the speed and much easier to lose the control of the bicycle.
- When using it in rainy days, please slow down the riding speed and use the brake in advance to brake gradually. Do not break suddenly at high speed to avoid side slide.
- 4) If the frame lock or the quick release is not tightened up, you may fall down and hurt or the bicycle may be damaged.
- 5) Before every cycling, please check the condition of each quick release to ensure they are tightened up. (The standard locking force is 6~8kgf)
- 6) This bicycle is provided only for riding on general or slightly bumpy road.

6 Torque of screw components

Torque recommended for the fasteners of handlebar straight, handlebar stem, saddle, saddle tube and wheel

► Handlebar, headset, seat cushion and seat post

Assembly	In/1bs	Nm	kg f/cm
Hexagonal packing nut	115-145	13-16.4	132-167
Four tube clamp bolts for the handlebar straight	120-145	13.6-16.4	138-167
Seat slide clamp	35-60	4-6.8	40-69
Front/rear wheel set screw torque	/	/	36

► Frame and front fork

Assembly	In/1bs	Nm	kg f/cm
Torque of the fender installation bolt	50-60	5.6-6.8	58-69

► Brake-rim, disc pad and brake rod

Assembly	In/1bs	Nm	kg f/cm
Disc-brake to hub	55	6.2	63

► Crank group, bottom bracket tube and pedal area

Assembly	In/1bs	Nm	kg f/cm
Pedal to crank	307	34.7	353
Crank bolt (square shaft)	300-395	33.9-44.6	345-454
Bottom bracket	432-606	49.1-68.9	500-702

► Front and rear hub QR and the nut fixing axle

Assembly	In/1bs	Nm	kg f/cm
Freewheel to hub (rotating freewheel)	260-434	29.4-49	299-499
Front axial to the front fork	260-434	29.4-49	299-499
Rear axial to the frame	260-434	29.4-49	299-499

5 Components regulation

Regulation, disassembly and assembly of the relevant components of the bicycle

1) Regulation of the quick release

- ① Unlock the quick release.
- ② Regulate the screw of the quick release manually to regulate the tightness of the quick release (as shown in Figure 17).
- ③ Lock the quick release.

2) Regulation of the tightness of the frame folding device

- ① Unlock the insurance of the folding device to open it.
- ② Loosen the flat head screw stopper on the folding strut(as shown in Figure 18), regulate the screw of the folding device(as shown in Figure 19) to make it to a proper tightness, and tighten up the flat head screw stopper.

3) Regulation of the tightness of the stem folding device

- ① Screw off the screw bolt of the folding device (as shown in Figure 20), open the folding device.
- ② 2.Regulate the sunflower lifting screw(as shown in Figure 21), adjust the folding device to suitable tightness, screw up the screw bolt.



Figure 17



Figure 18



Figure 19



Figure 20



Figure 21

5 Components regulation

4) Regulation of the seat cushion

- ① Loosen the two screws on the seat tube coupling by basic hand tool (as shown in Figure 22) and regulate the saddle horizontally.
- ② Tighten up the screws after completing the regulation.



Figure 22

5) Regulation of the braking system

① Regulation of disc-brake

Use a hex wrench to regulate the tightness of the screws of disc-brake (as shown in Figure 23) to adjust the height of the disc-brake lining shoe for the tightness regulation for the brake.



Figure 23

5 Components regulation

② Fine adjustment of disc-brake

Regulate the tightness of the screws of disc-brake (as shown in Figure 24) or the tightness of the screws on brake cable housing (as shown in Figure 25) to adjust the brake stroke.



Figure 24



Figure 25

6) Disassembly and assembly of fender

- ① Use the basic hand tool to unscrew the screws of the fender (as shown in Figure 26-27) to disassemble the fender.
- ② Replace a new fender and tighten up the fender screws.

Screws of front fender



Figure 26

Screws of rear fender



Figure 27